



Project	
Nomenclature	
Type	Date
Approval	
Notes	

This superior-grade LED decorative retail fixture is ideal for indoor use, where energy efficiency, performance and ease of maintenance is essential. Its rugged design and superior light paths make it an ideal fixture for low and high bay applications

Luminaire Summary

Features

- Operating temperature ranges available from -40C to 40C
- L70 of 110,000+ hours, L90 of 34,000+ hours
- Standard 0 - 10V dimming
- Available in 2700K, 3000K, 3500K, 4000K, 5000K and 6500K
- Lumen packages are available ranging from 2' 1.75L (1750lm) to 8' 23L (23000lm)

Approvals

- ETL certified to UL Canada and United States standards
- Made with UL Listed components
- DLC Listed

Mounting

- Holes provided for V-hangers, S-hook chain-mounting, or aircraft cables
- Optional pendant mount and surface mount brackets

Construction

- Manufactured in Ontario, Canada
- Cold-rolled steel parts are precision bent for added strength and rigidity
- Access panel provided for easy wiring
- Powder-coated finish in low-gloss white

Electrical

- Available in 120-277V, 120-347V, 347V and 480V

Options

- Custom lengths available
- Wireless Controls Available
- 90 and 95+ CRI Options Available
- 120-347V(UN3) Available

Ordering Information

Fill in the fields below with your product selections. If you need help with this section, [contact your local sales professional.](#)



1	2	3	4	5
BLLB				

Series	Lumen Output		CRI	Colour Temp	Voltage		
BLLB	2' 1.75L	1750lm	8' 9L	9000lm	8 - 80 CRI	27 - 2700K	UNV - 120-277V
	2' 2.25L	2250lm	8' 11L	11000lm	9 - 90 CRI	30 - 3000K	UN3 - 120-347V
	2' 2.75L	2750lm	8' 13L	13000lm	1 - 95+ CRI	35 - 3500K	347 - 347V
	4' 4.5L	4500lm	8' 15L	15000lm		40 - 4000K	480 - 480V
	4' 5.5L	5500lm	8' 17L	17000lm		50 - 5000K	
	4' 6.5L	6500lm	8' 19L	19000lm		65 - 6500K	
	4' 7.5L	7500lm	8' 21L	21000lm			
	4' 8.5L	8500lm	8' 23L	23000lm			
	4' 9.5L	9500lm	**L - Custom lumen package or length				
	4' 10.5L	10500lm					
	4' 11.5L	11500lm					

Options

- Lenses**
- L0 No Lens
 - L55 Clear Acrylic
 - L67 Frosted Acrylic

- Cords**
- W3xx White 16/3 (Specify Length)
 - W4xx Black 16/3 (Specify Length)
 - W59xx White 18/5 (Specify Length)
 - W*** Other Options Available*

Key.	Cord Length.	Key	Cord Length
6	6FT	15	15FT
10	10FT	20	20FT

Ex. W406 would be 16/3 Black, 6FT

- Dimming**
- B11 0-10V Dimming Leads
 - B12 Line Voltage Dimming
 - B27 Dim-to-off Driver

- Controls**
- WC10* Encelium Wireless Controls
 - WC18* NX Wireless Controls
 - WC19* Avi-on Wireless Controls
 - WC22* JDRF Wireless Controls

- Motion Sensors**
- W26 Photocell Motion Sensor
 - W57 Dimming Motion Sensor (dims to 50% when unoccupied)
 - W53* On/Off
 - W8* High/Low
 - WX16 Microwave Dimmable Sensor
 - W** Other Options Available*

- Wire Guard**
- G1 Heavy Duty White
 - G5 Heavy Duty Black

- Emergency Driver**
- B17 UL924 10W Battery Back-up
 - F8 UL924 Emergency Relay

- Packaging**
- BLANK Individually Boxed on Pallets
 - P0 Bulk Packaging
 - P** Other Options Available*

- Mounting**
- M1 V-Hangers
 - M2xx V-Hanger with Aircraft Loop Cables
 - M3xx Y-Toggle Aircraft Cables
 - M24 Single Pendant Mount(3/4 Hub)
 - M25 Surface Mount
 - M** Other Options Available*

Key.	Aircraft Length.	Key	Aircraft Length
5	5FT	15	15FT
10	10FT	20	20FT

Ex. M305 would be Y-Toggle, 5FT

- Modular Wiring**
- W27XYZC Modular Power Cable
 - W22XY Molex Row Mounting Wiring

- Baffles**
- J31 White Louver
 - J47 Black Louver

- Warranty**
- CL7 10-Year Comprehensive Warranty Upgrade

Documentation and Resources

All files and resources are available on our website for download. Files and resources are also embedded as links in this document, listed below. Additional files may be available upon request. Please contact your local sales agent [here](#) or contact sales@bjtake.com for more information.

- BLLB-4FT-4.5L-840-UNV-L67
- BLLB-4FT-5.5L-840-UNV-L67
- BLLB-4FT-6.5L-840-UNV-L67
- BLLB-4FT-7.5L-840-UNV-L67
- BLLB-4FT-8.5L-840-UNV-L67
- BLLB-4FT-9.5L-840-UNV-L67
- BLLB-4FT-10.5L-840-UNV-L67
- BLLB-4FT-11.5L-840-UNV-L67
- BLLB-8FT-9L-840-UNV-L67
- BLLB-8FT-11L-840-UNV-L67
- BLLB-8FT-13L-840-UNV-L67
- BLLB-8FT-15L-840-UNV-L67
- BLLB-8FT-17L-840-UNV-L67
- BLLB-8FT-19L-840-UNV-L67
- BLLB-8FT-21L-840-UNV-L67
- BLLB-8FT-23L-840-UNV-L67

Certifications and Listings

Certifications that apply to this fixture and its possible configurations are listed here. More information available upon request.

Icon	Description
	Wireless Controls Available
	DLC Listed
	ETL Listed
	90 and 95+ CRI Options Available
	120-347V(UN3) Available

Usage Applications

This fixture can be used in a variety of applications, and is ideal for the following:

Usage Application
Manufacturing Facilities
Storage & Warehousing
Gymnasiums
Retail Stores
Grocery Stores

Warranty Statement

BJ Take products are tested and/or inspected prior to being packaged for shipment and are guaranteed from the day the product is shipped for a period of ten-year LED chip warranty and a five-year comprehensive component warranty. This can be upgraded to a ten-year comprehensive warranty on request.

BLLB, 2 Foot, Side Dims

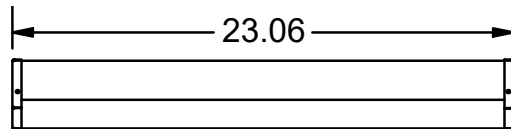

2FT End View

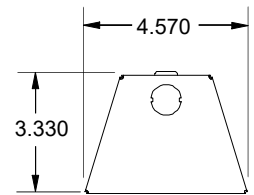

BLLB, 3 Foot, Side Dims

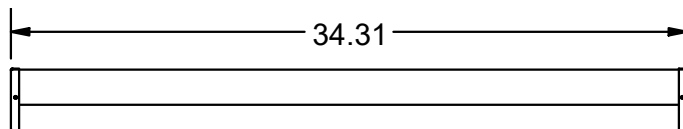

3FT End View

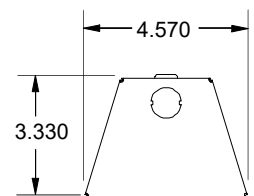

BLLB, 4 Foot, Side Dims

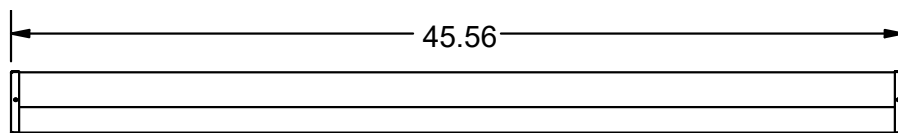

4FT End View

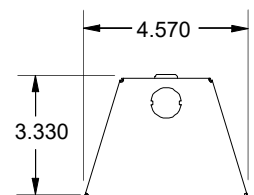

BLLB, 6 Foot, Side Dims

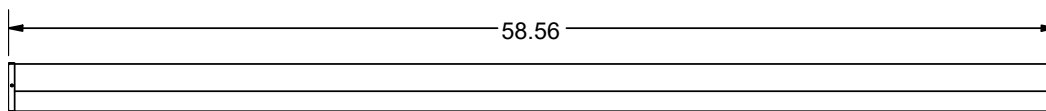

6FT End View

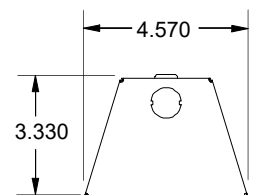

BLLB, 8 Foot, Side Dims

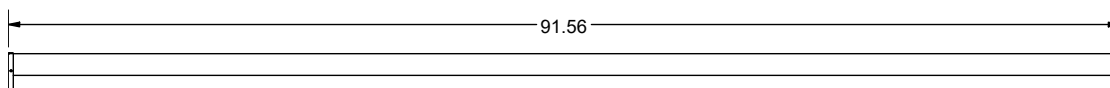

8FT End View

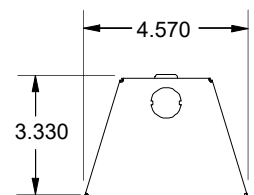

- * Drawings aren't to scale
- * Standard tolerances apply
- * Specifications may change without notice

Important Information

Below you will find the available wattage charts for the BLLB. For any required specifications that are not listed here, please contact our sales team at sales@bjtake.com to request any additional information.

BLLB, 2 Foot Wattage

Size	Lumen Output	Actual Lumen Output	Fixture Wattage	Lumens per Watt
2'	1.75	1758	13.00	135.40
2'	2.25	2755	20.60	134.00
2'	2.75	3238	24.40	132.60

BLLB, 3 Foot Wattage

Size	Lumen Output	Actual Lumen Output	Fixture Wattage	Lumens per Watt
3'	3.00	3000	22.10	135.50
3'	4.00	3987	29.70	134.10
3'	4.50	4461	33.60	132.70
3'	5.00	4922	37.50	131.30
3'	5.50	4372	41.40	129.90
3'	6.00	5809	45.20	128.50
3'	6.50	6235	49.10	127.10
3'	7.50	6654	52.90	125.70

BLLB, 4 Foot Wattage

Size	Lumen Output	Actual Lumen Output	Fixture Wattage	Lumens per Watt
4'	4.50	4521	33.40	135.40
4'	5.50	5509	41.10	134.00
4'	6.50	6475	48.80	132.60
4'	7.50	7419	56.50	131.20
4'	8.50	8342	64.30	129.80
4'	9.50	9242	72.00	128.40
4'	10.50	10121	79.70	127.00
4'	11.50	10984	87.50	125.60

BLLB, 6 Foot Wattage

Size	Lumen Output	Actual Lumen Output	Fixture Wattage	Lumens per Watt
6'	6.75	6749.50	49.80	135.50
6'	8.25	8224.00	61.30	134.10
6'	9.75	9666.00	72.80	132.70
6'	11.25	11075.00	84.40	131.30
6'	12.75	12453.00	95.90	129.90
6'	14.25	13797.50	107.40	128.50
6'	15.75	15108.00	118.90	127.10
6'	17.25	16396.50	130.50	125.70

BLLB, 8 Foot Wattage

Size	Lumen Output	Actual Lumen Output	Fixture Wattage	Lumens per Watt
8'	9	8978	66.20	135.60
8'	11	10939	81.50	134.20
8'	13	12857	96.90	132.70
8'	15	14731	112.20	131.30
8'	17	16564	127.50	129.90
8'	19	18353	142.80	128.50
8'	21	20095	158.10	127.10
8'	23	21809	173.50	125.70

BLLB, Light Loss Factor (LLF)

CCT	Output%
2700K	92.95
3000K	95.51
3500K	96.80
4000K	100.00
5000K	101.28
90CRI	84.72

BLLB-8FT-15L-840-UNV-L67

Cone of Light

Mtg Height	Light Level	Beam Diameter
6.0 ft	152.6 fc	16.5 ft
8.0 ft	85.8 fc	22.0 ft
10.0 ft	54.9 fc	27.5 ft
12.0 ft	38.1 fc	33.0 ft
14.0 ft	28.0 fc	38.5 ft
16.0 ft	21.5 fc	44.0 ft

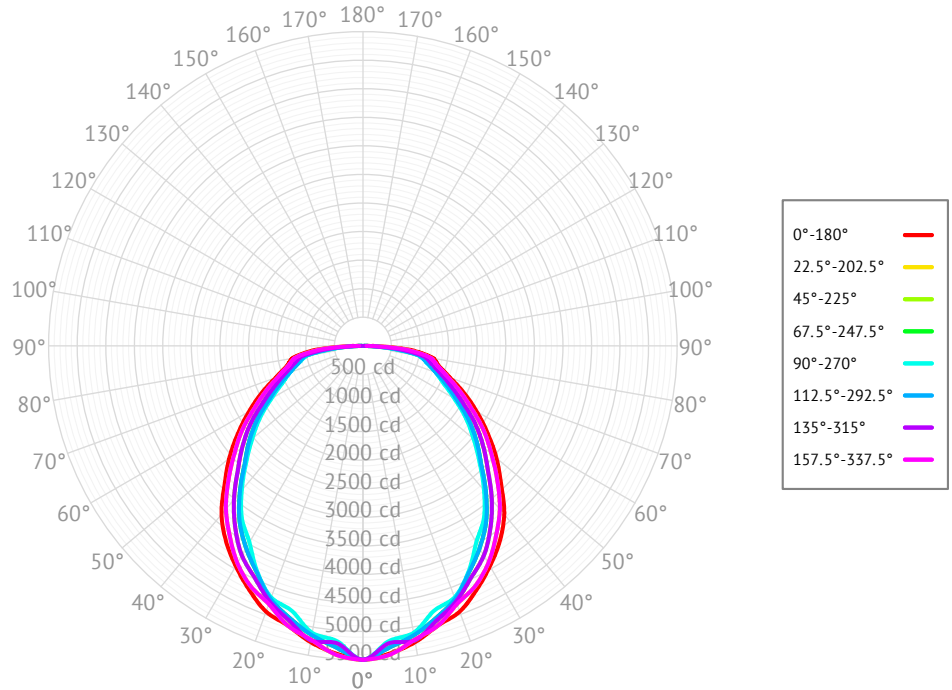

Based on 'BLLB-8FT-15L-840-UNV-L67', ie. (BLLB, 8 foot, 15000lm, 80 CRI, 4000K, w/ L67 Lens)

Modular Wiring

The BLLB has options for modular wiring. Below you will find the diagrams for these wiring options, and the relevant option codes necessary for ordering them.

W22XY - Molex Row Mounting Wiring

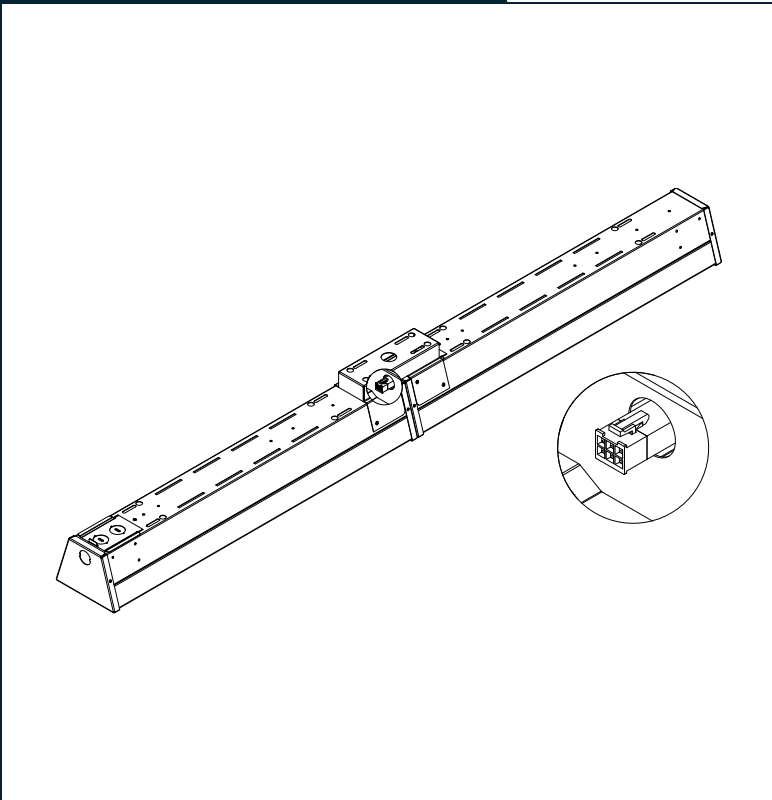

W27XYZC - Modular Power Cable

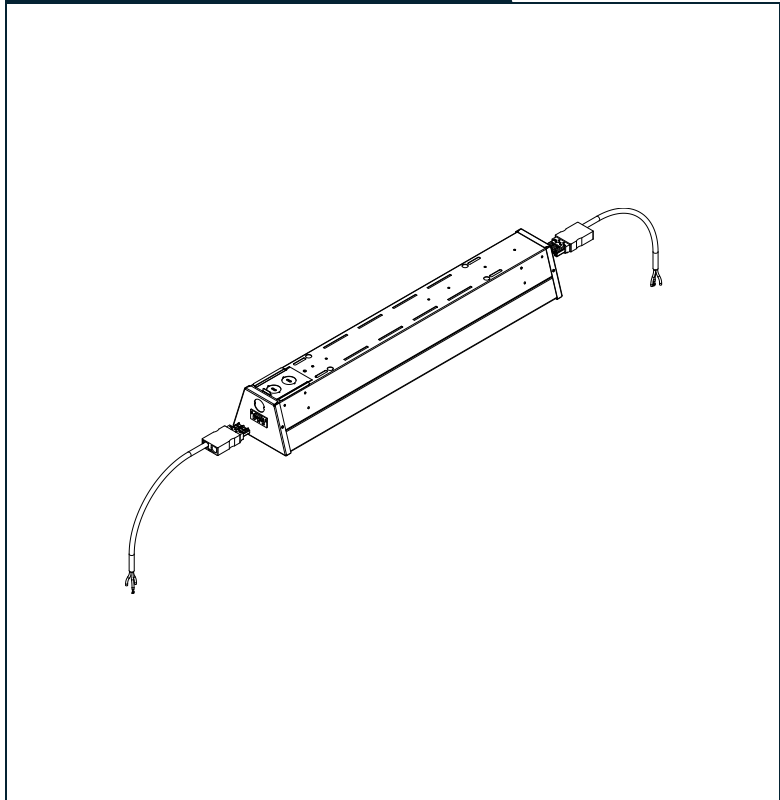

W22XY - Molex Row Mounting Wiring

X - Style	Y - Poles
E - End	3 - 3 Pole
.	4 - 4 Pole
.	5 - 5 Pole
.	6 - 6 Pole

Example: **W22E6** (see image above)

W27XYZC - Modular Power Cable

X - Style	Y - Poles	Z - Wiring	C - Colour
S - Side	3 - 3 Pole	Blank - Standard	Blank - White
E - End	4 - 4 Pole	E - End of Row	B - Black
T - Top	5 - 5 Pole	.	G - Grey
.	6 - 6 Pole	.	.

Example: **W27E3** (see image above)

Emergency Battery Plan - 10W

Emergency Lighting	Solution System Components	System Operation
Option Code 'B17' - UL 924 listed components that are factory installed in the luminaire	UL 924 listed 10-watt battery integral to the luminaire	Loss of normal power is detected by the B17 emergency light solution and the power supply is switched automatically to the 10-watt integral battery pack which powers the emergency LED lighting driver.
	UL 924 listed LED emergency lighting driver integral to the luminaire	The battery pack and emergency LED driver are UL 924 certified to provide a minimum of 90-minutes of emergency lighting.
	Wiring options for both switched and unswitched emergency lighting	

Emergency Lighting Wiring

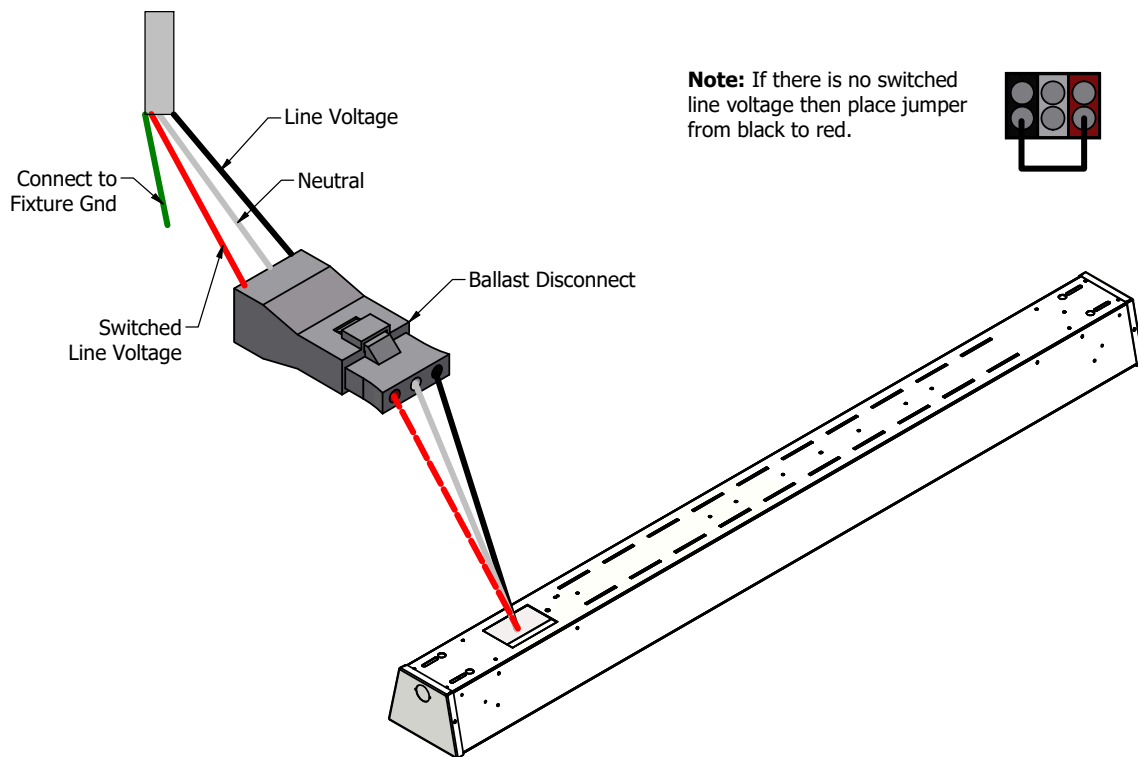

Important Information

More information on emergency lighting options and configurations available on request.